

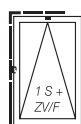

PRIMAT-FL 190

ZV/F

- Ⓓ Montageanleitung
- ⒼⒷ Mounting instructions
- Ⓕ Instructions de montage
- ⒶⒼ Montage handleiding
- Ⓘ Istruzioni di montaggio
- Ⓔ Instrucciones de montaje
- ⒹⒼ Montaj talimatı
- ⒶⒼ Instrukcja montażowa
- ⒶⒼ Инструкция по монтажу

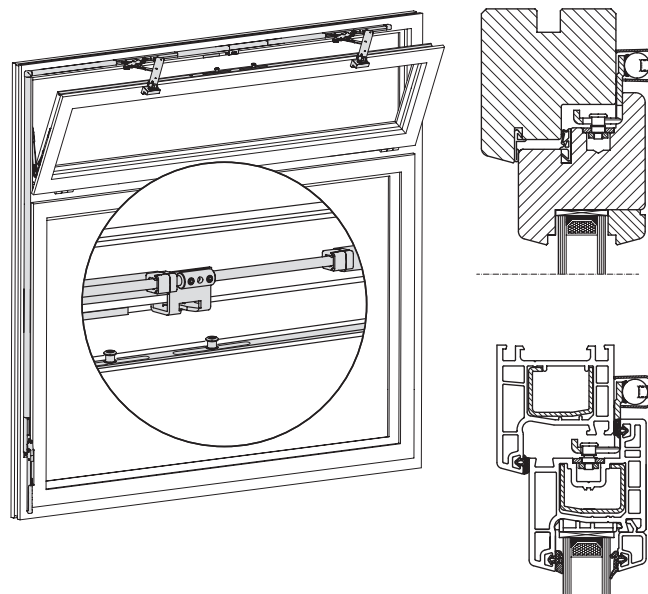
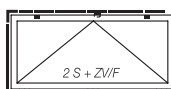
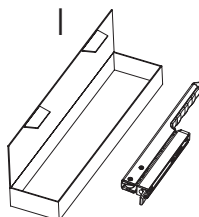
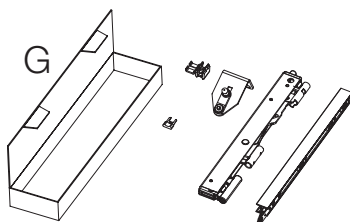
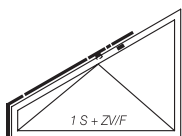
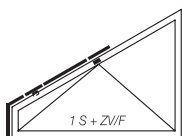
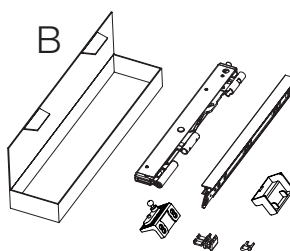
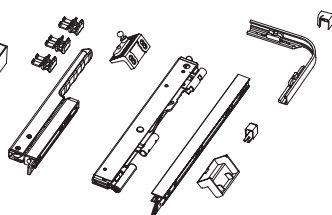
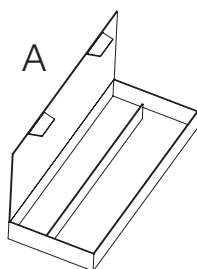
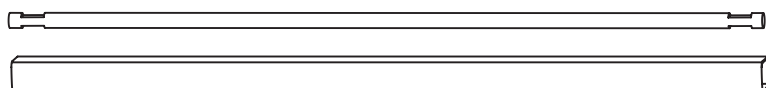

 $1 \times A + 1 \times O$

 $1 \times A + 1 \times B + 1 \times O$

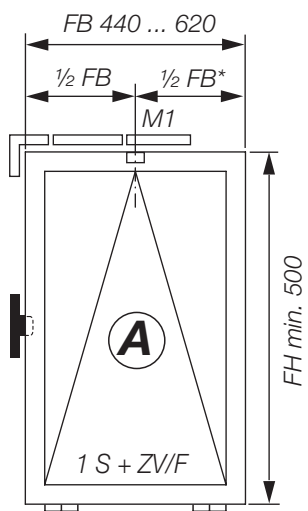
 $1 \times G + 1 \times I +$
 $1 \times F + 1 \times O$

1000, 2000, 2500, 3000, 3750 mm

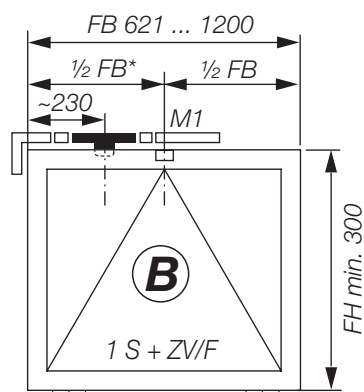
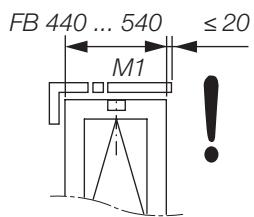
2000, 3000, 6000 mm



*FB 440 ... 500 = (M1) 250



*FB 621 ... 740 = (M1) 370

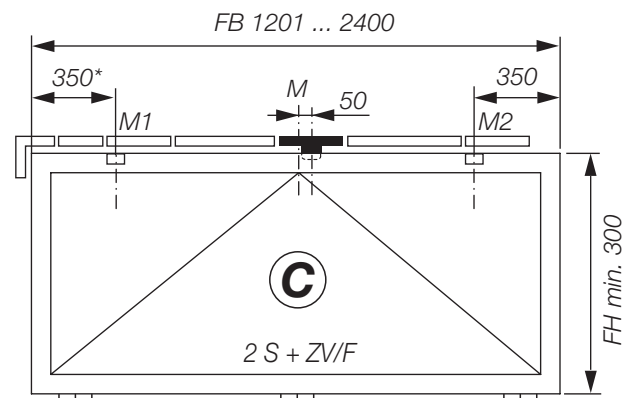
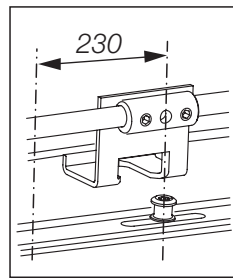

*FB 1200 ... 1300 = (M1) 300

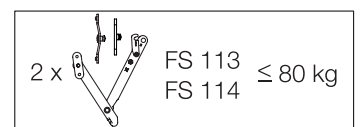
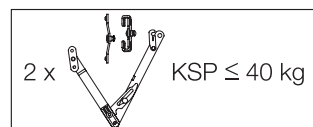
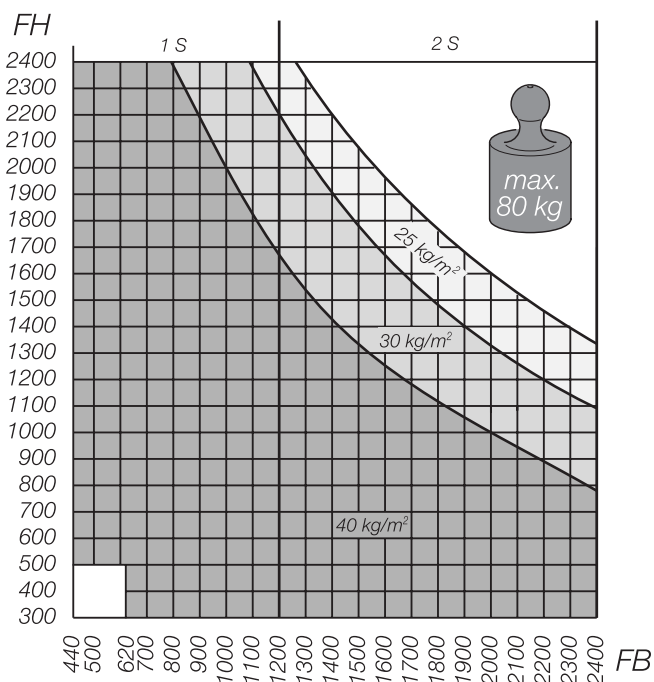
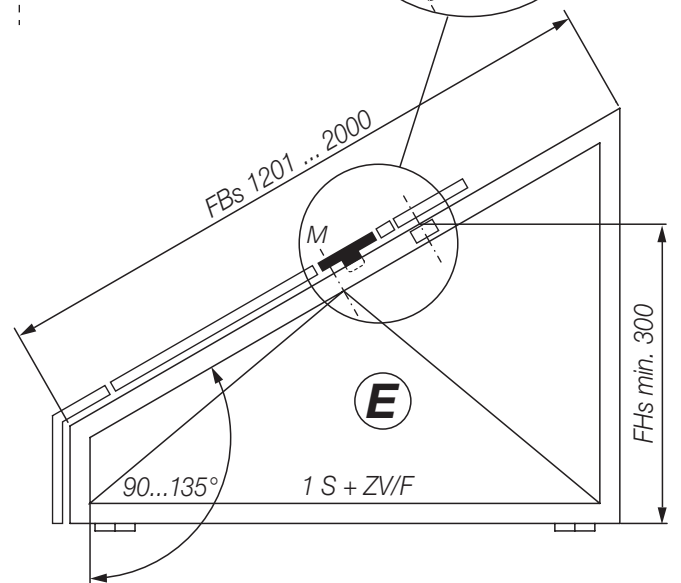
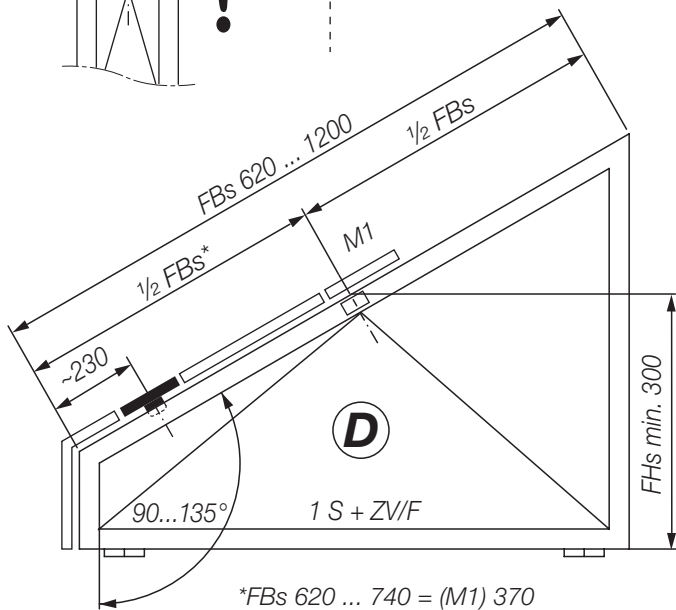
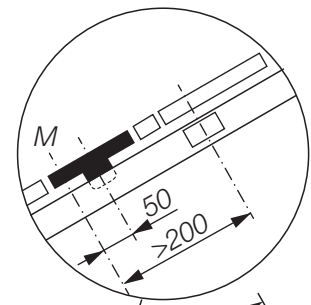
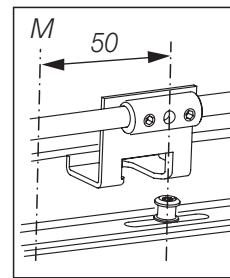

$\emptyset 3,2$
 $\emptyset 8,0$

$\emptyset 3,9 \times \dots$

ds = 14
do = 14

$\emptyset 3,9 \times \dots$

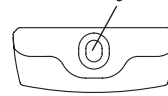

$\emptyset 4,0 \times 50$

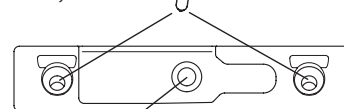

$\emptyset 4,0 \times 30$

$\emptyset 4,0 \times 30$

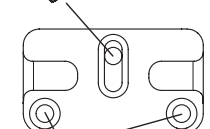

$\emptyset 4,0 \times 50$

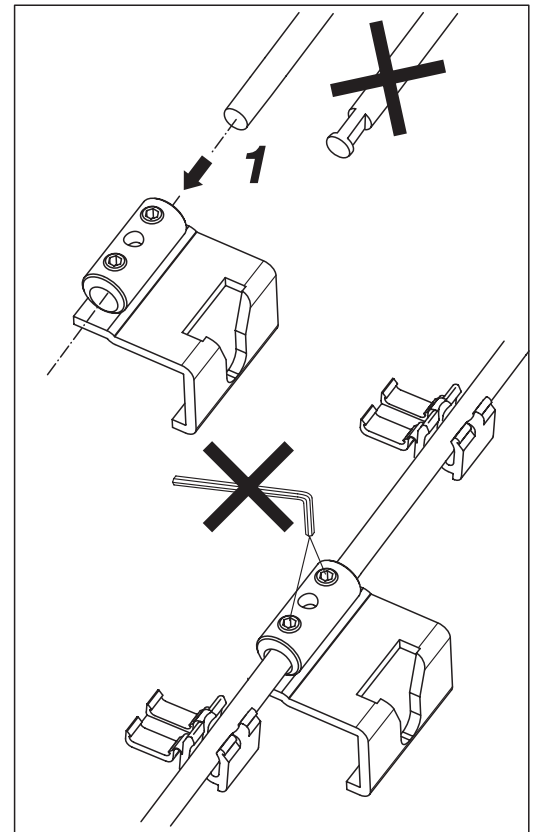
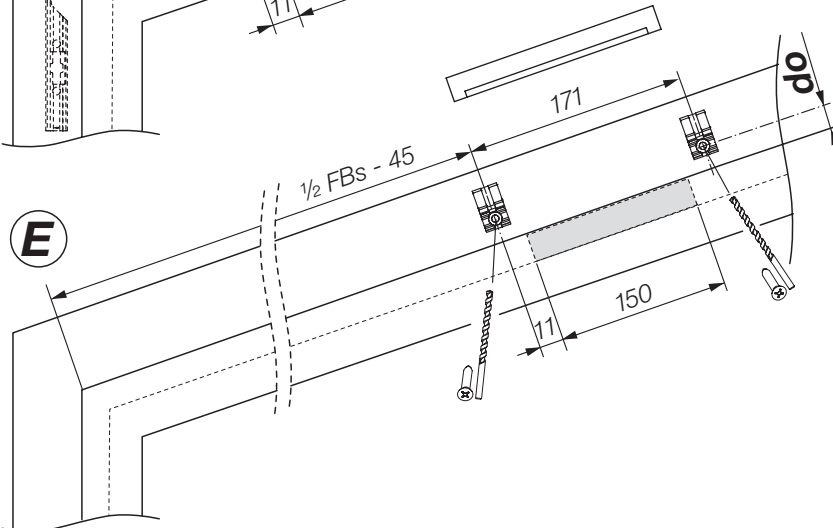
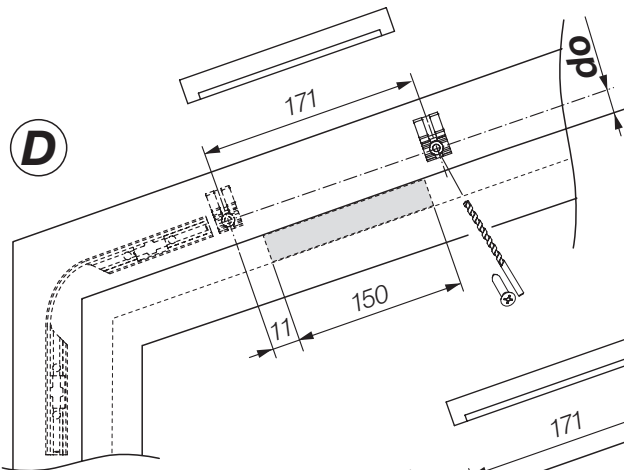
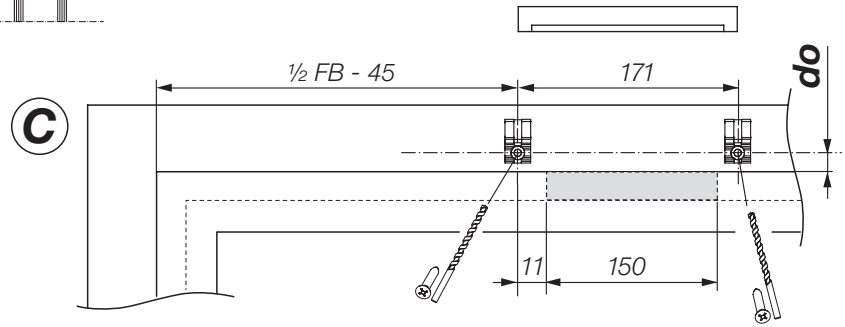
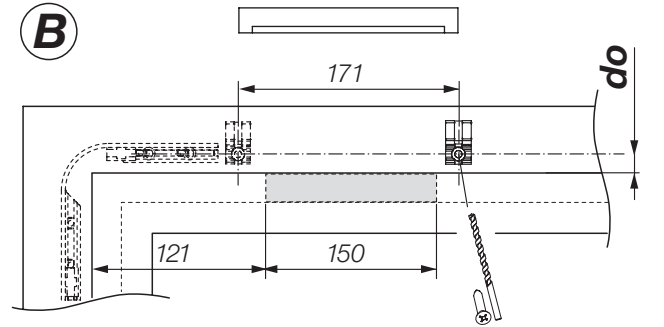
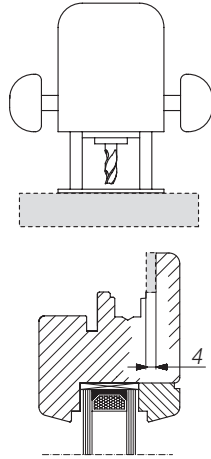
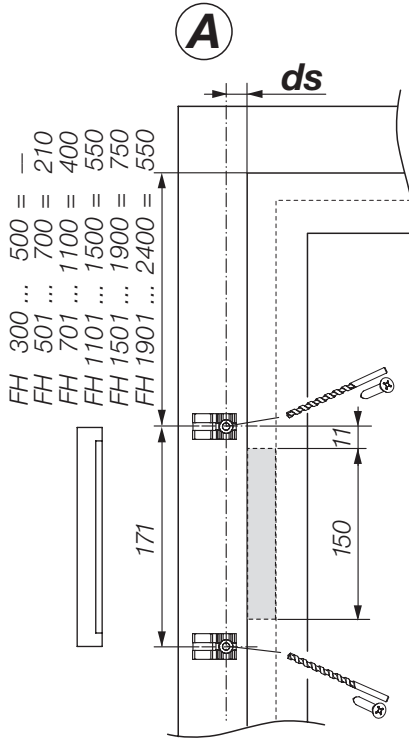
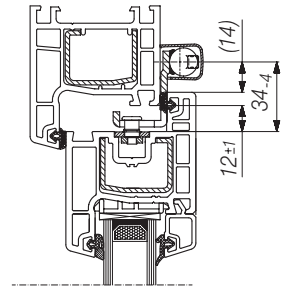
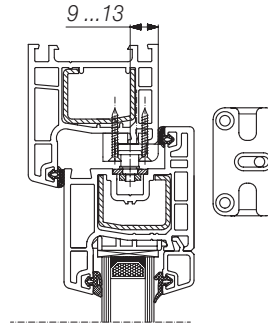
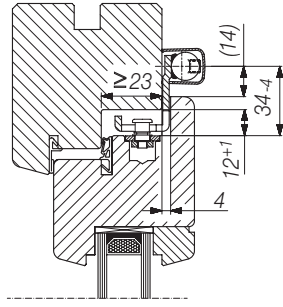
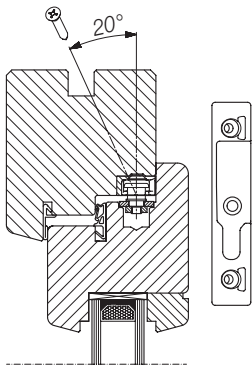

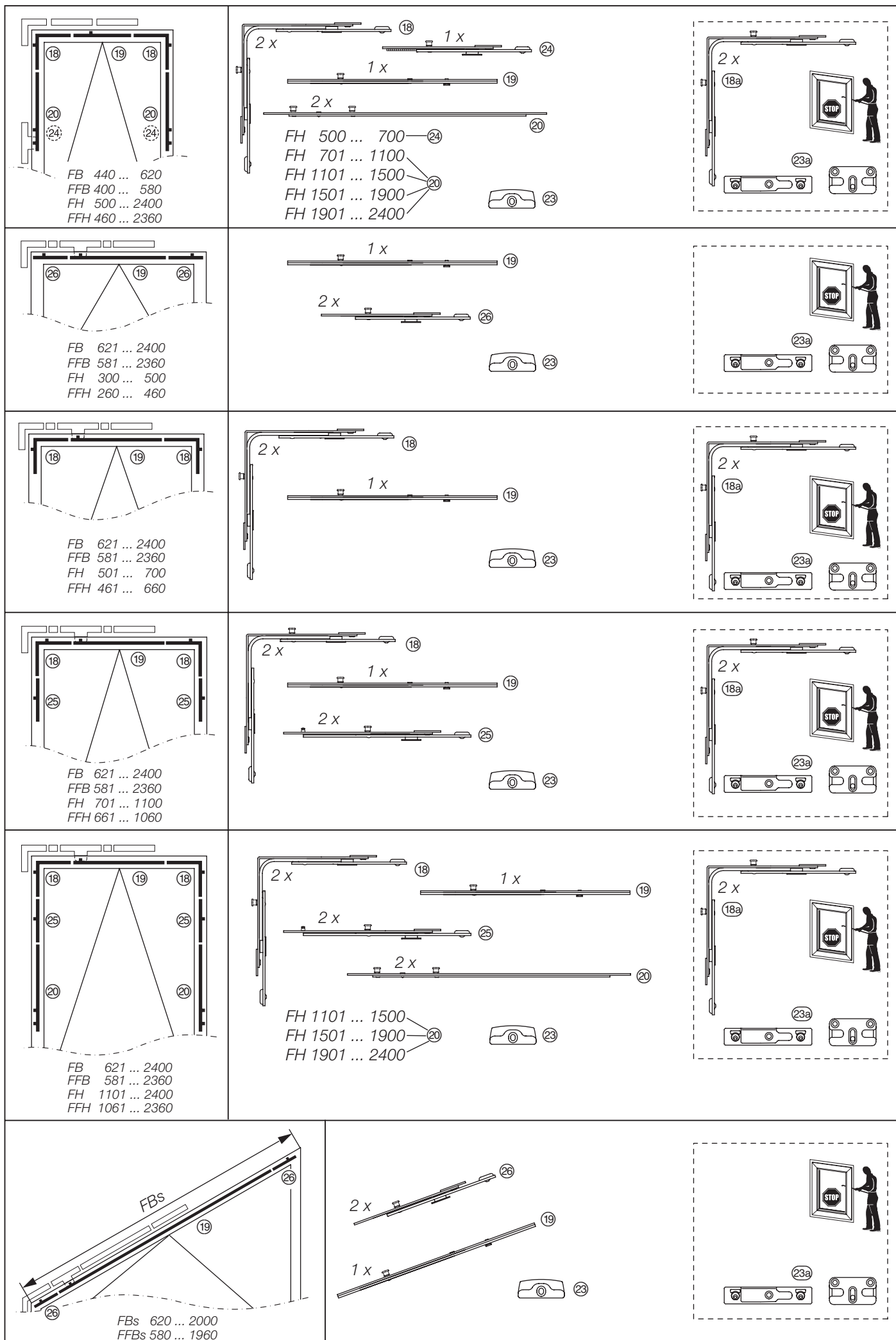

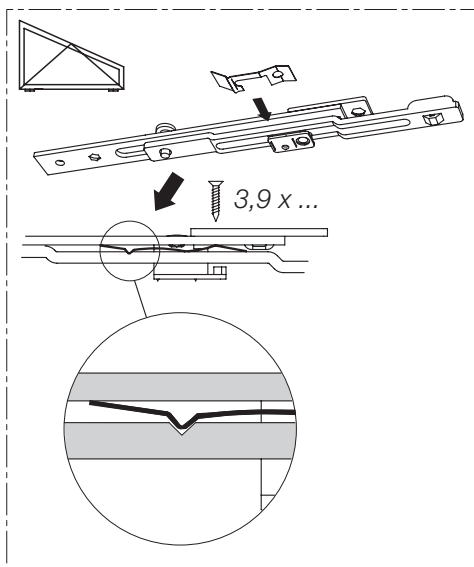

FB 440 ... 620
(FFB 400 ... 580)

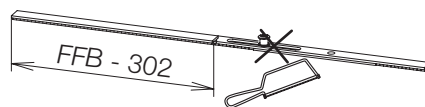

FB 621 ... 1200
(FFB 581 ... 1160)

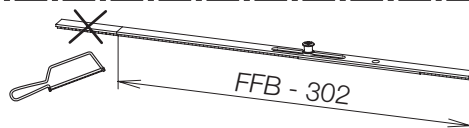

FB 1201 ... 2400
(FFB 1161 ... 2360)

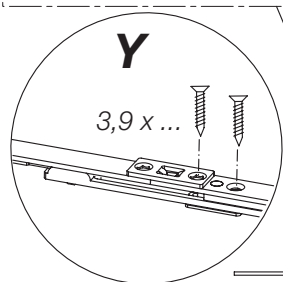
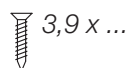
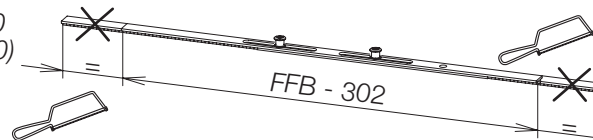

1 (FH 300 ... 500)

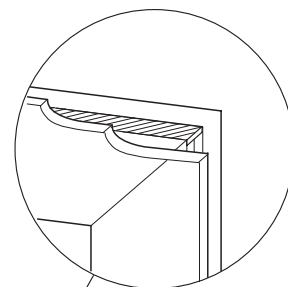
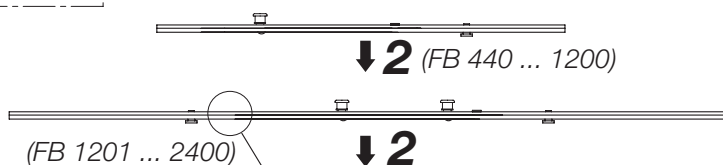

1 (FH 300 ... 500)

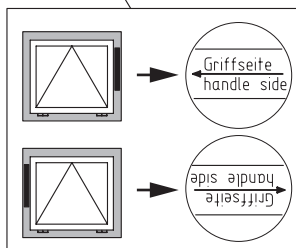

3,9 x ...

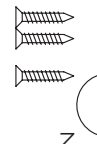

3,9 x ...



3,9 x ...



3,9 x ...



3,9 x ...



3,9 x ...



3,9 x ...



3,9 x ...

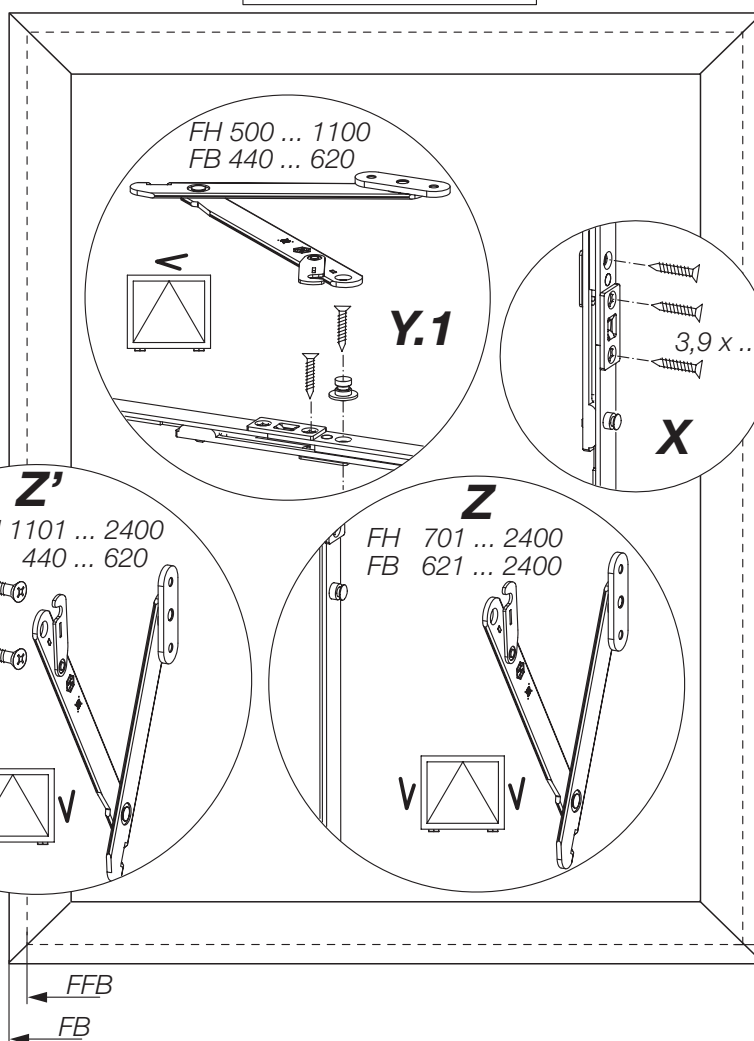

3,9 x ...

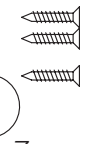

3,9 x ...



3,9 x ...



3,9 x ...



3,9 x ...



3,9 x ...



3,9 x ...



3,9 x ...



(...) =

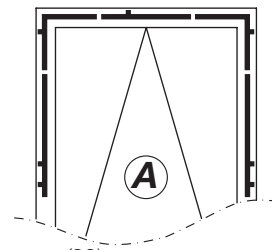
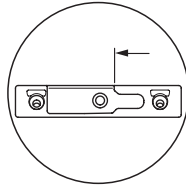
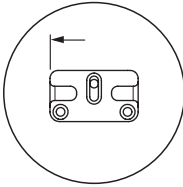
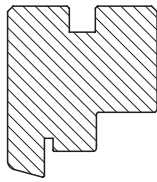
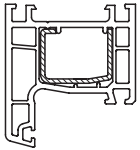
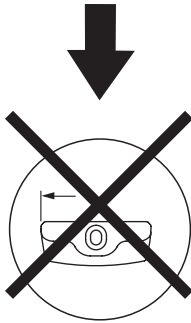

FB 440 ... 620
FH 500 ... 2400

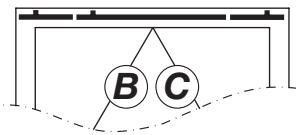
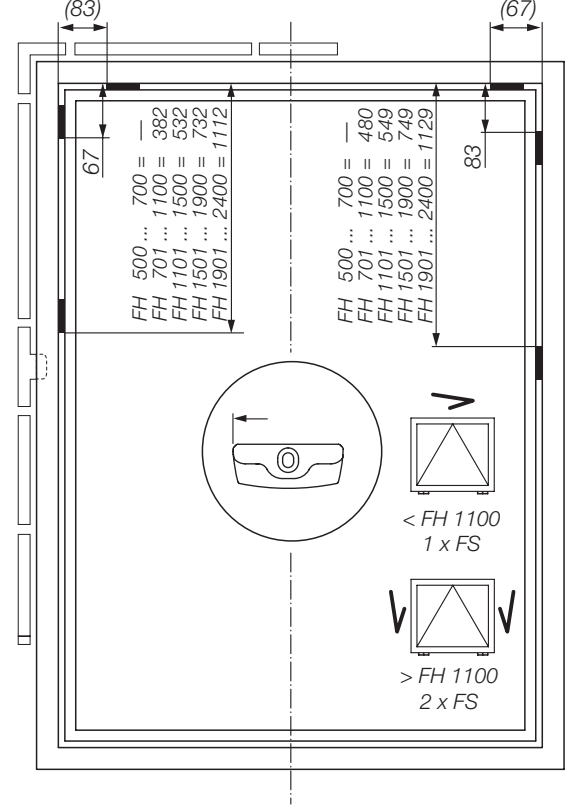

FB 621 ... 2400
FH 300 ... 500

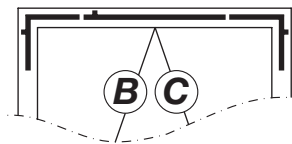

FB 621 ... 2400
FH 501 ... 700

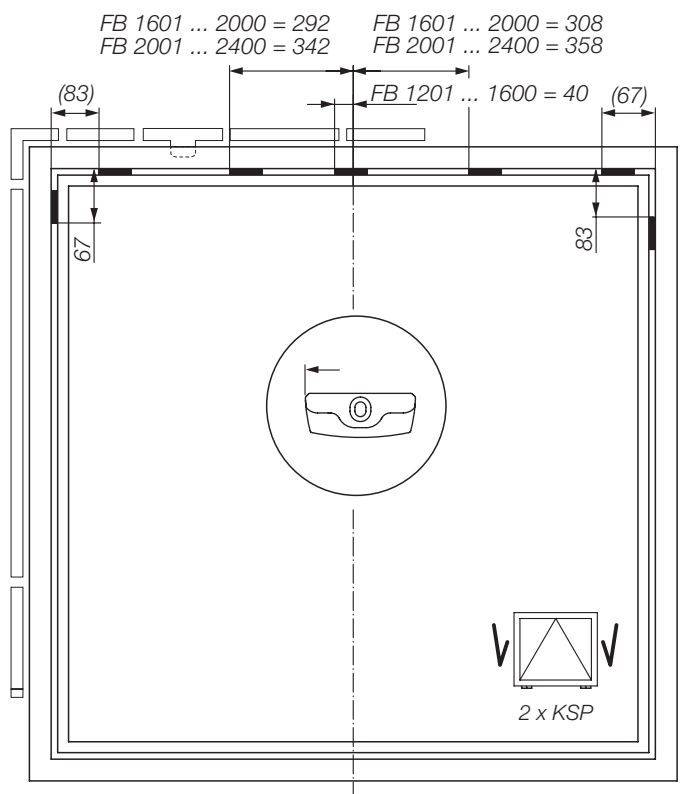
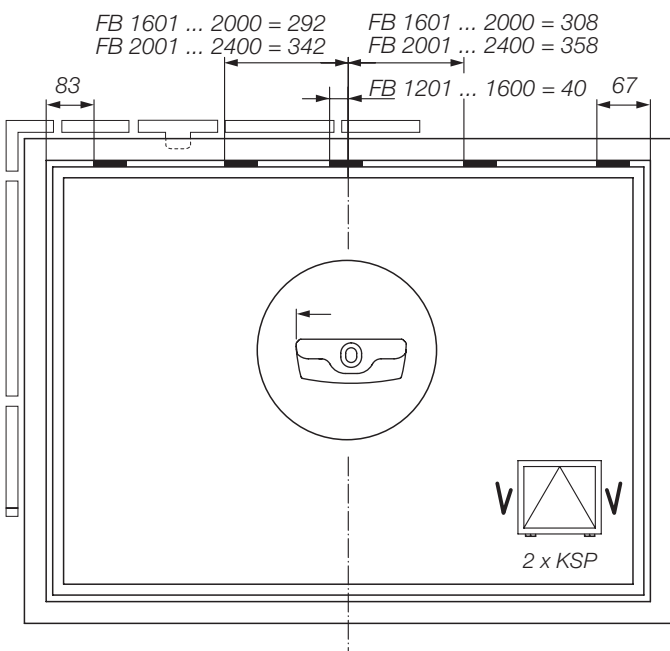



(...) =

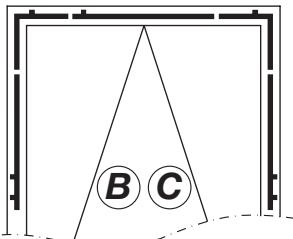
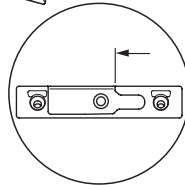
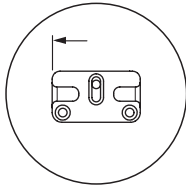
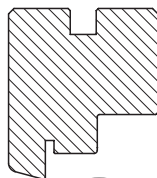
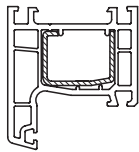

FB 621 ... 2400
FH 1101 ... 2400

FB 1601 ... 2000 = 292 FB 1601 ... 2000 = 308
FB 2001 ... 2400 = 342 FB 2001 ... 2400 = 358

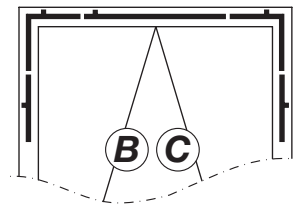
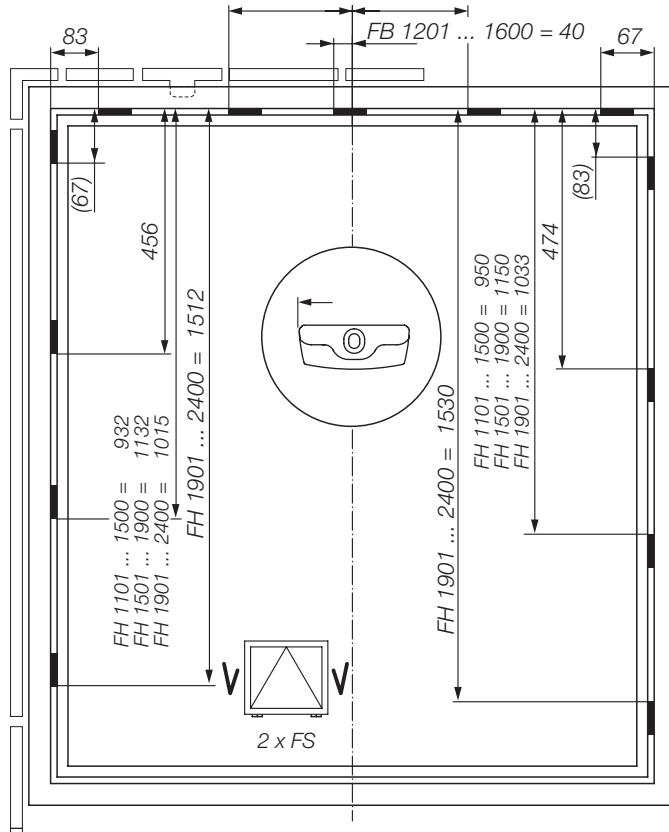

FB 621 ... 2400
FH 701 ... 1100

FB 1601 ... 2000 = 292 FB 1601 ... 2000 = 308
FB 2001 ... 2400 = 342 FB 2001 ... 2400 = 358

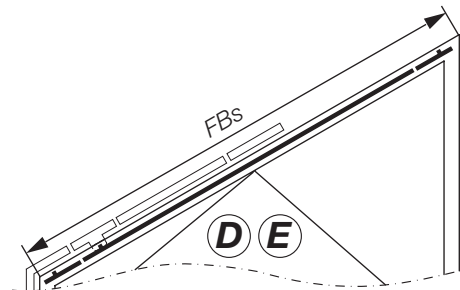
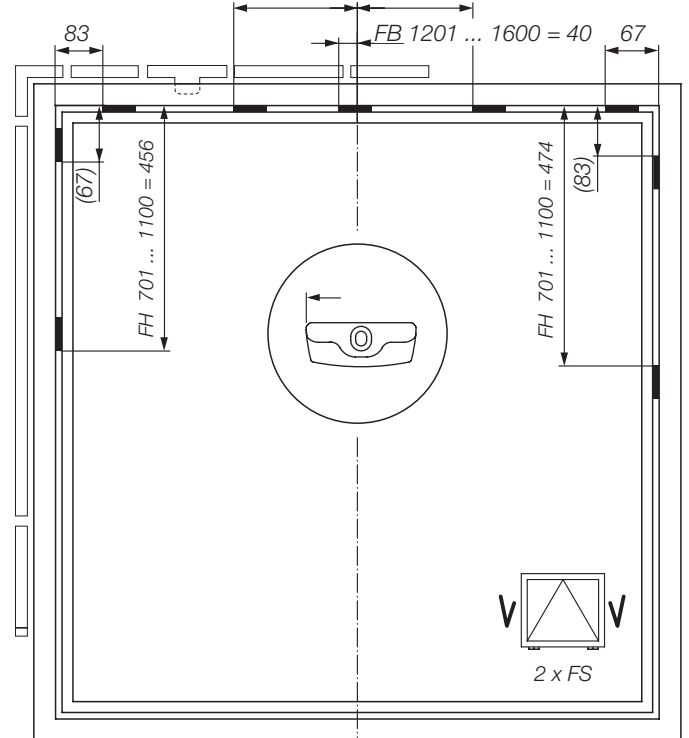

FBs 620 ... 2000

