

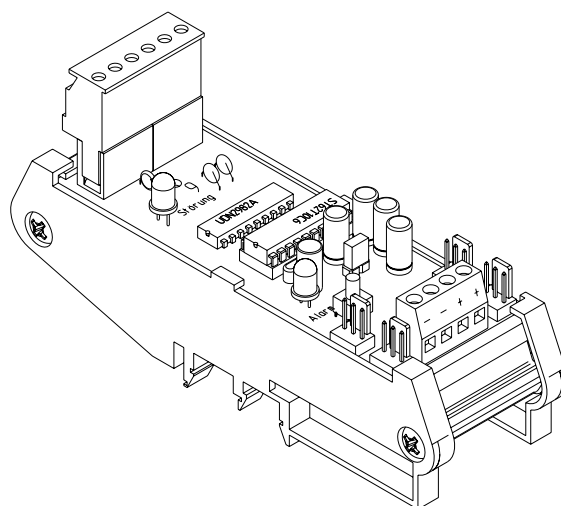

Datasheet

Signal module SM 9



General

The signal module is composed of a 6-pin terminal ① for connecting additional devices such as alarm sirens or flashlights, which will be activated in the event of an alarm or malfunction, and an external “Reset” button that can be used to reset the siren and the flashlight. The output signal can either be set to permanent or limited to 20 to 240 s per potentiometer (time1, time2) for the siren and flashlight.

The time voltage is measured at the contacts ④.
The voltage values are assigned to the time according to the table.
In emergency power mode, the signal is limited to 180 s.
Jumper J1 ③ can be used to set operation at intervals for the outputs (2 s On, 10 s Off). The “Reset” button on the circuit board has the same function as the external reset button (resetting the siren and the flashlight). The alarm and malfunction signals on the RWA bus can be switched off individually by jumpers J2, J3 ⑤.

Technical specifications

Supply voltage	24 V DC max. 32 V
Connection	1 flashlight 1 siren
Outputs	24 V DC - 0,5 A
Display “Alarm” ②	red LED
Ventilation or smoke and heat exhaust ventilation bus (LB)	+24 V active
Fuse	max. 1 A
Space requirement	37 mm

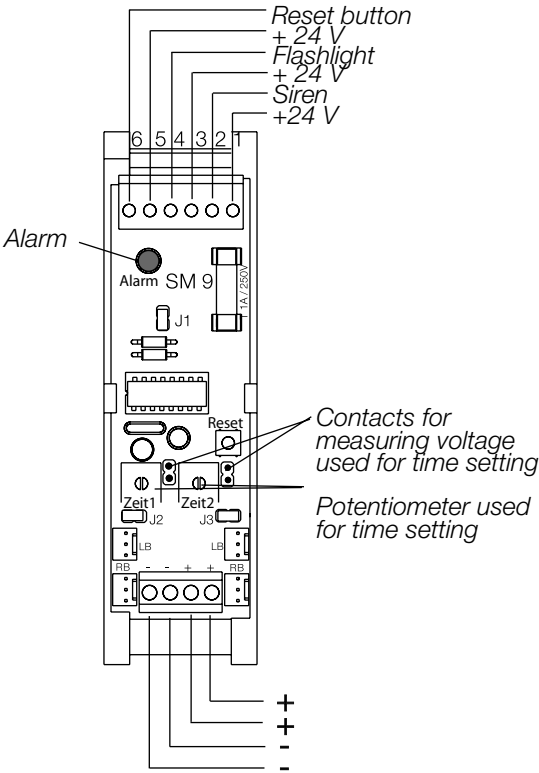
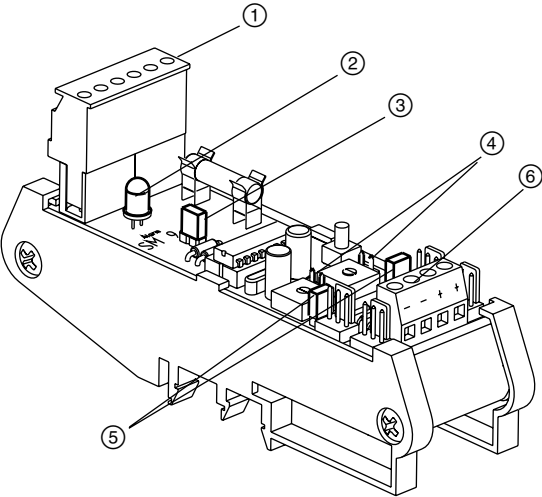
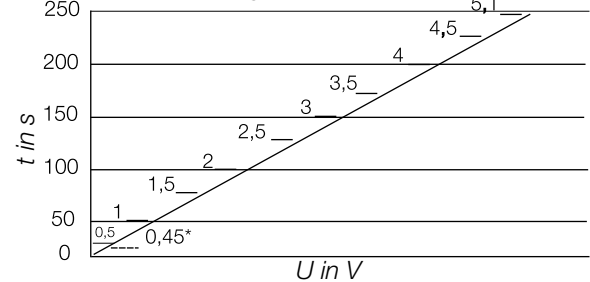

Table for time setting at output



V	5,1	4,5	4	3,5	3	2,5	2	1,5	1	0,5	0,45*
s	240	225	200	165	150	125	100	75	50	25	20

* Settings below 0,45 V will be interpreted as a permanent

Installation

Voltage is supplied by a four-pin terminal ⑥ via strands of the same size (2,5 mm²). The wires to the external devices are connected to the 6-pin plug-in terminal according to the terminal diagram. The internal wiring of the smoke and heat exhaust ventilation (RB) and the ventilation bus (LB) is connected via three-pin jumpers.