

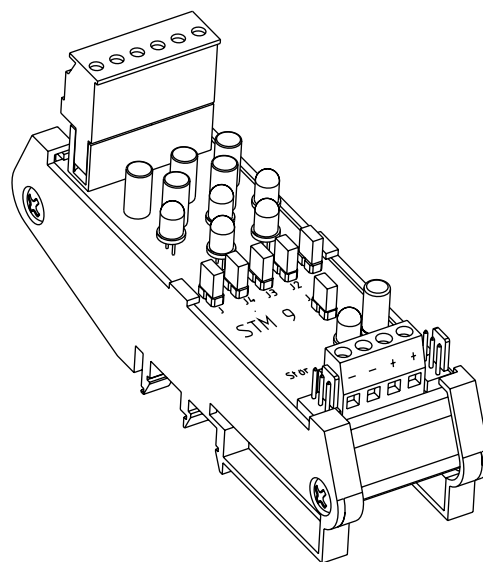

Datasheet

Fault module STM 9



General

The fault module is used for monitoring the wires of star-wired drives. Up to 5 drive lines (lines 1-5) can be connected to the 6-pin terminal ①; their status is indicated by the corresponding green LED. Each line can be switched off separately with jumpers (J1-J5) ⑤. A malfunction is indicated by a yellow LED and transmitted to the smoke and heat exhaust ventilation bus. Forwarding the malfunction as an emergency stop signal to the group module (motor terminal 3 in GS 9 module) can be switched off by jumper (J6) ③.

Technical specifications

Supply voltage	24 V DC max. 32 V
Display ②	5x green LED
Malfunction ④	1x yellow LED
Ventilation or smoke and heat exhaust ventilation bus (LB)	+24 V active
Space requirement	37 mm

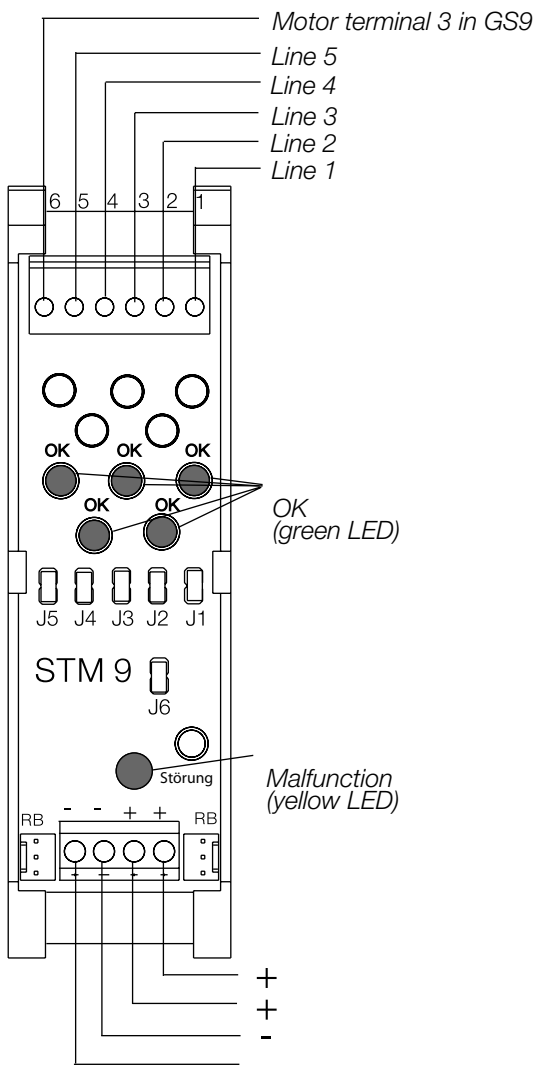
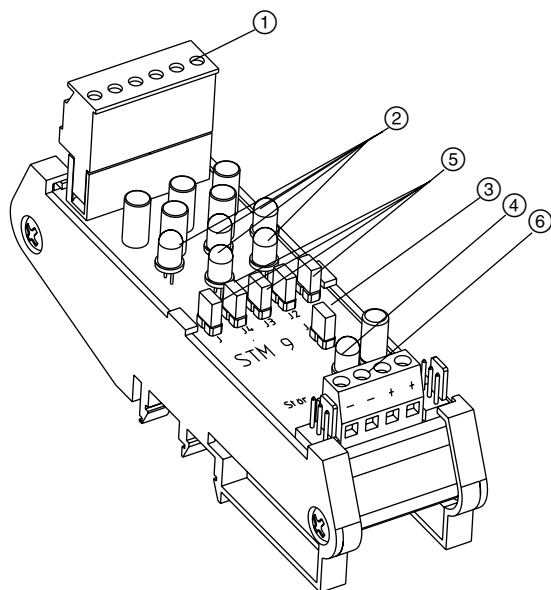

Installation

Voltage is supplied by a four-pin terminal ⑥ via strands of the same size (2,5 mm²). The wires to the external devices are connected to the 6-pin plug-in terminal according to the terminal diagram. The internal wiring of the smoke and heat exhaust ventilation (RB) and the ventilation bus (LB) is connected via three-pin jumpers.