

# ATRIUM® Alu-HKS 200

## Use of drilling jigs/tools



### Drilling jigs/tools for ...

#### NOTE:

This document is only valid in combination with the following mounting instructions:

**ATRIUM® Alu-HKS 200 Z**, article code: 233590,

**ATRIUM® Alu-HKS 160 S**, article code: 233596,

**ATRIUM® Alu-HKS 160 S oV**, article code: 233938.

The figures refer to systems Left (or Right as per DIN EN 12519).

For systems right (or left as per DIN EN 12519), the dimensions have to be adapted mirrored.

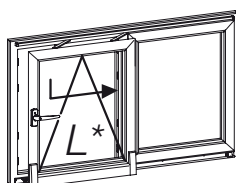
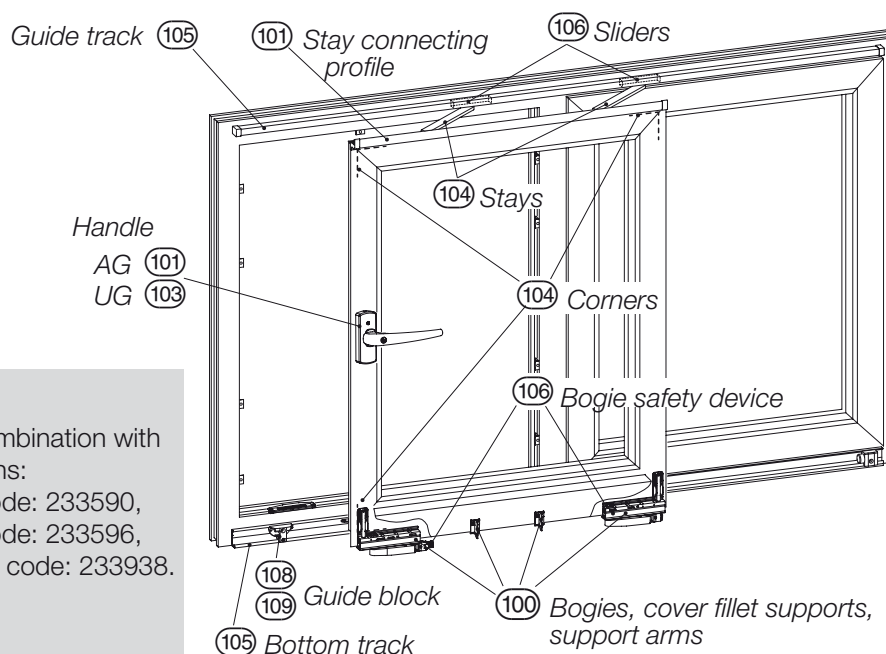

\*DIN EN 12519 Right  
(right-opening)

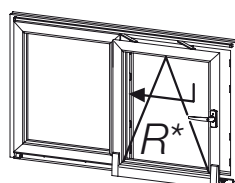

\*DIN EN 12519 Left  
(left-opening)

## Content

Jig for ...	for fitting Alu-HKS ...	Jigs / tools	Page
Corners, stays	200 Z	(104) 206860	2
Handle for gear with fork drive (AG)	200 Z	(101) 234782	3
Handle for gear with fork drive (UG)	160 S	(103) 173281	3
Stay connecting profile	160 S / 160 S oV / 200 Z	(101) 234782	4
Bogies, cover fillet supports, support arms	160 S / 160 S oV / 200 Z	(100) 215277	5
TWIN bogies, cover fillet supports, support arms	200 Z	(100) 215277 (2x)	6
Guide track	160 S / 160 S oV / 200 Z	(105) 215256 / (107) 110747	7
Bottom track	160 S / 160 S oV / 200 Z	(105) 215256 / (107) 110747	8
Bogie safety device	160 S / 160 S oV / 200 Z	(106) 215283	9
Sliders	200 Z	(106) 215283	10
Guide block	160 S / 160 S oV / 200 Z	(108) 301394 / (109) 301352 (optional)	11

**All measurements in these instructions are indicated in millimetres (mm).**

## Corners, stays

### Mounting corners and stays for ATRIUM® Alu-HKS 200 Z

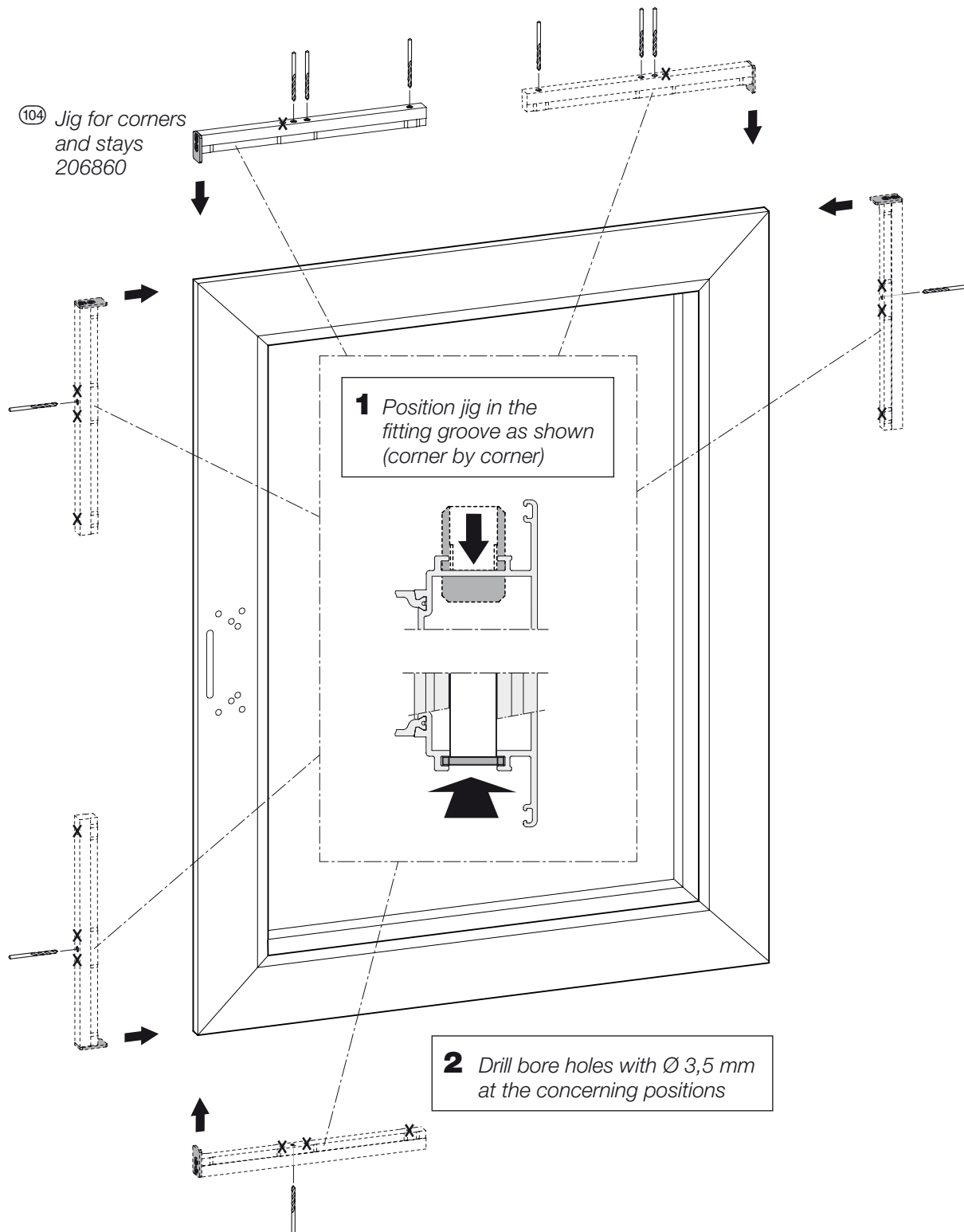

Handle for ...  
 ... gear with fork drive (UG),  
 ... gear with fork drive (AG)

### Mounting handle UG for ATRIUM® Alu-HKS 160 S

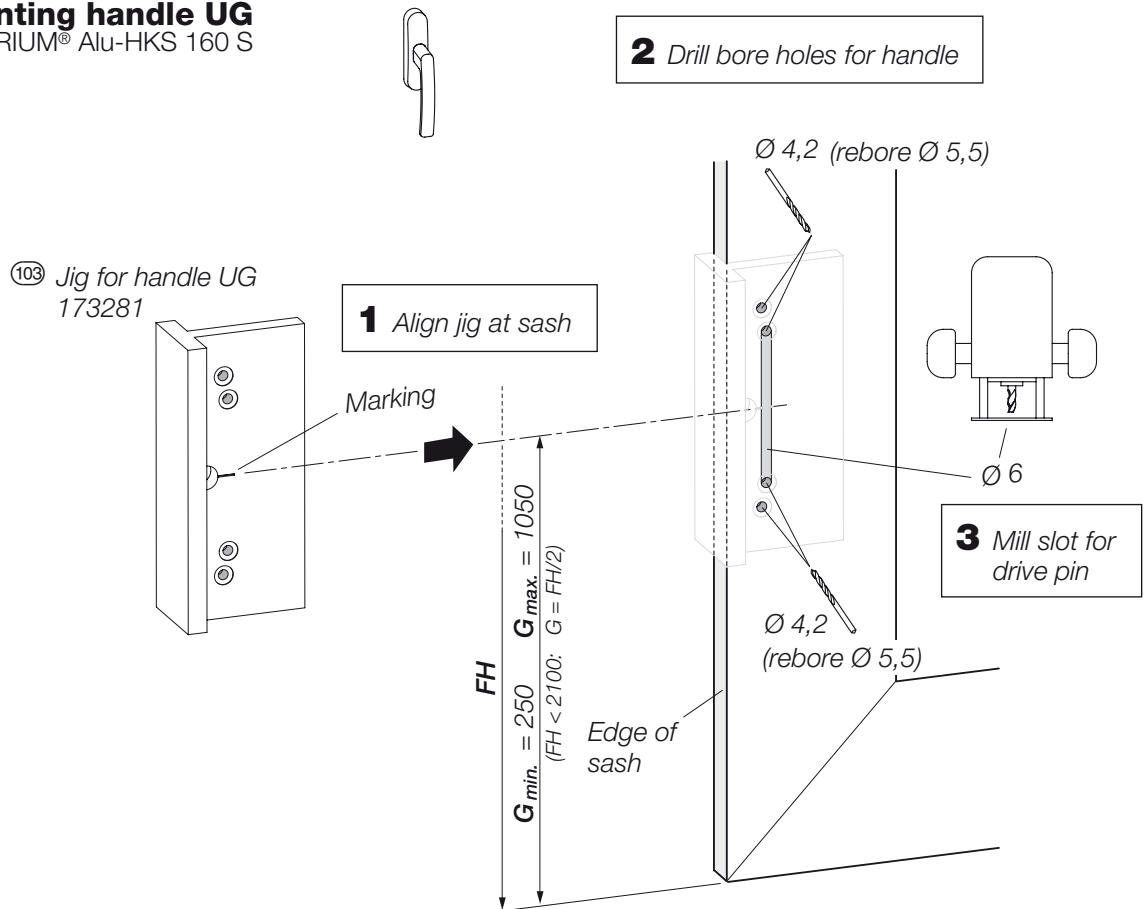

### Mounting handle AG for ATRIUM® Alu-HKS 200 Z

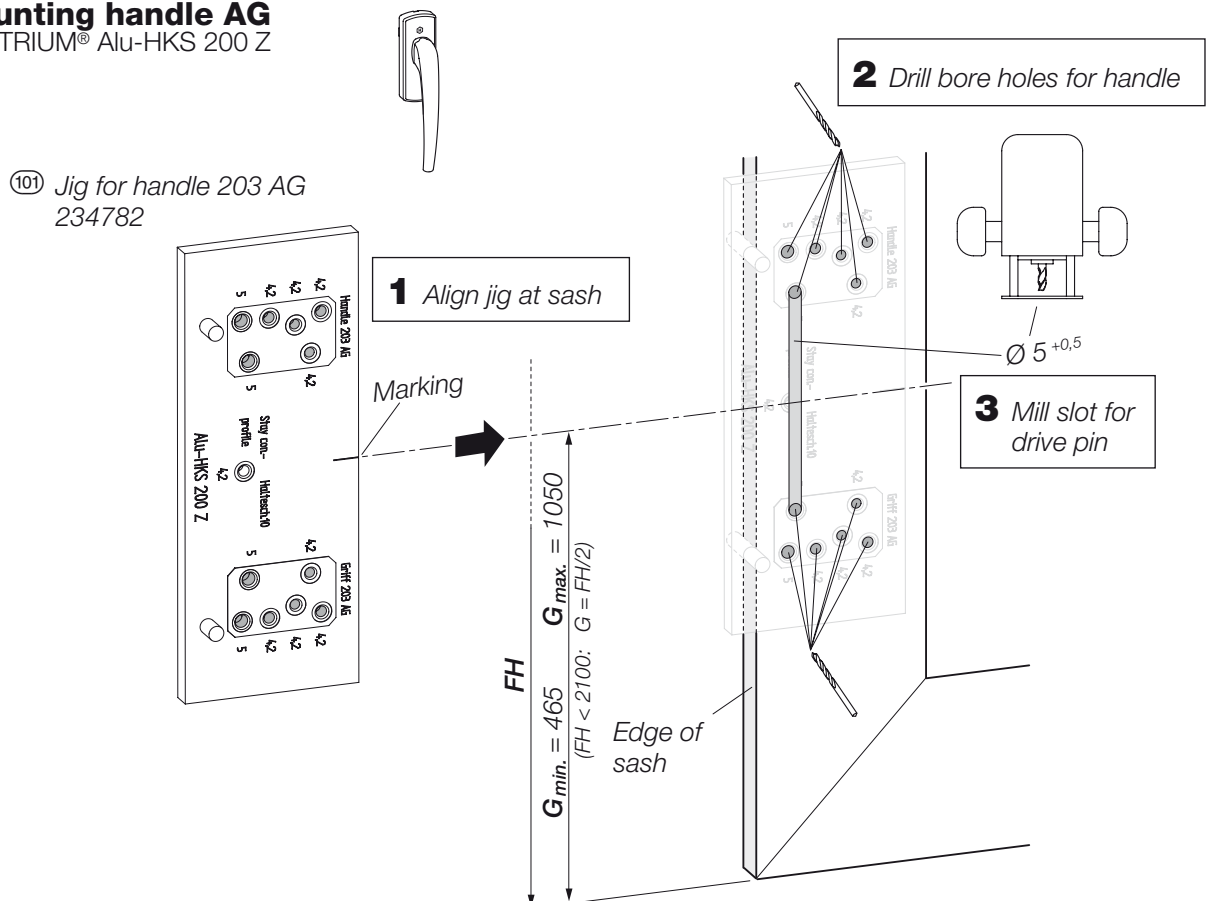

## Stay connecting profile

### Mounting stay connecting profile

for ATRIUM® Alu-HKS 160 S / 160 S oV / 200 Z

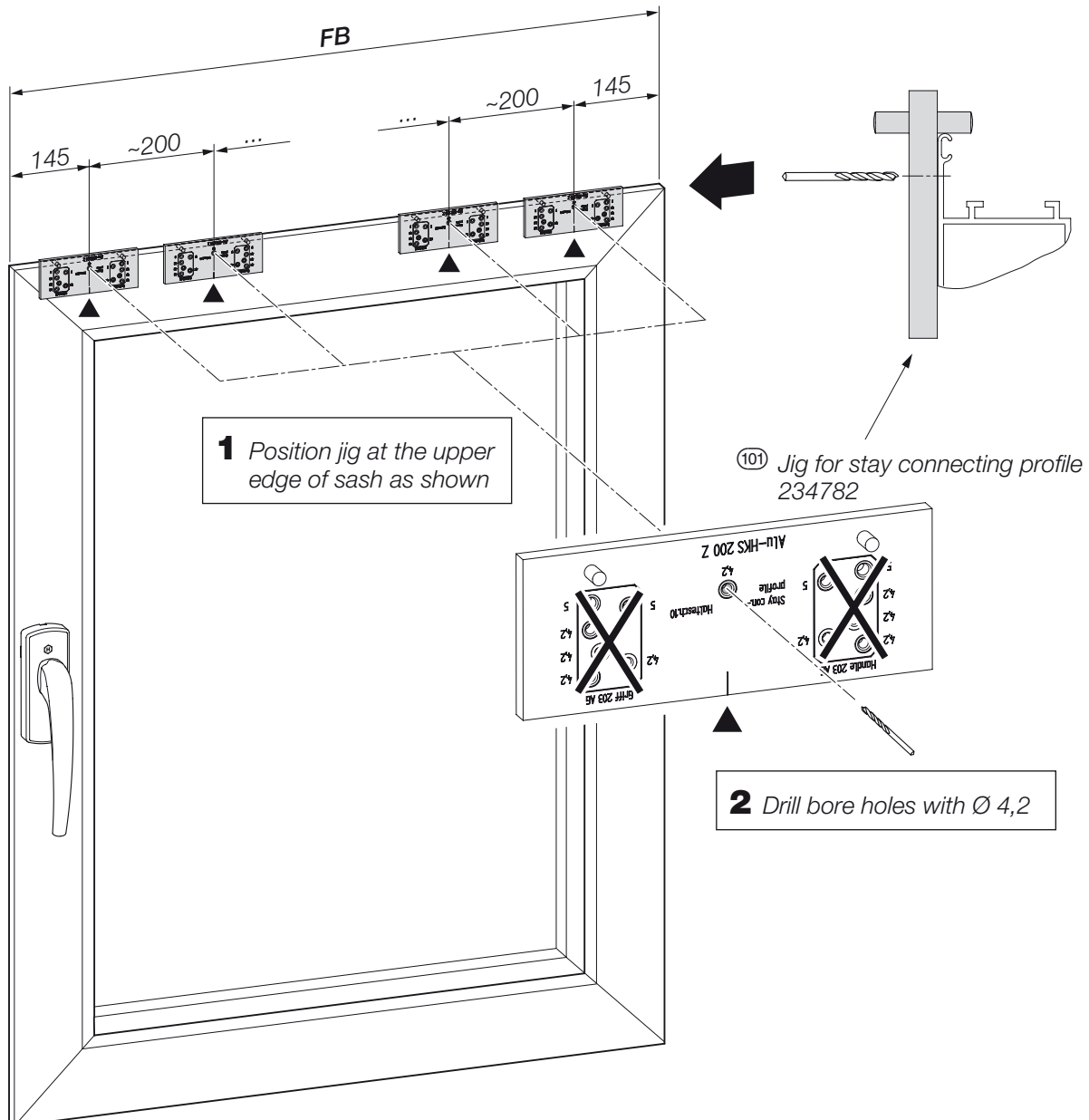

# Bogies, cover fillet supports, support arms

## Mounting bogies, cover fillet supports and support arms for ATRIUM® Alu-HKS 160 S / 160 S oV / 200 Z

Sash weight  $\leq 160$  kg

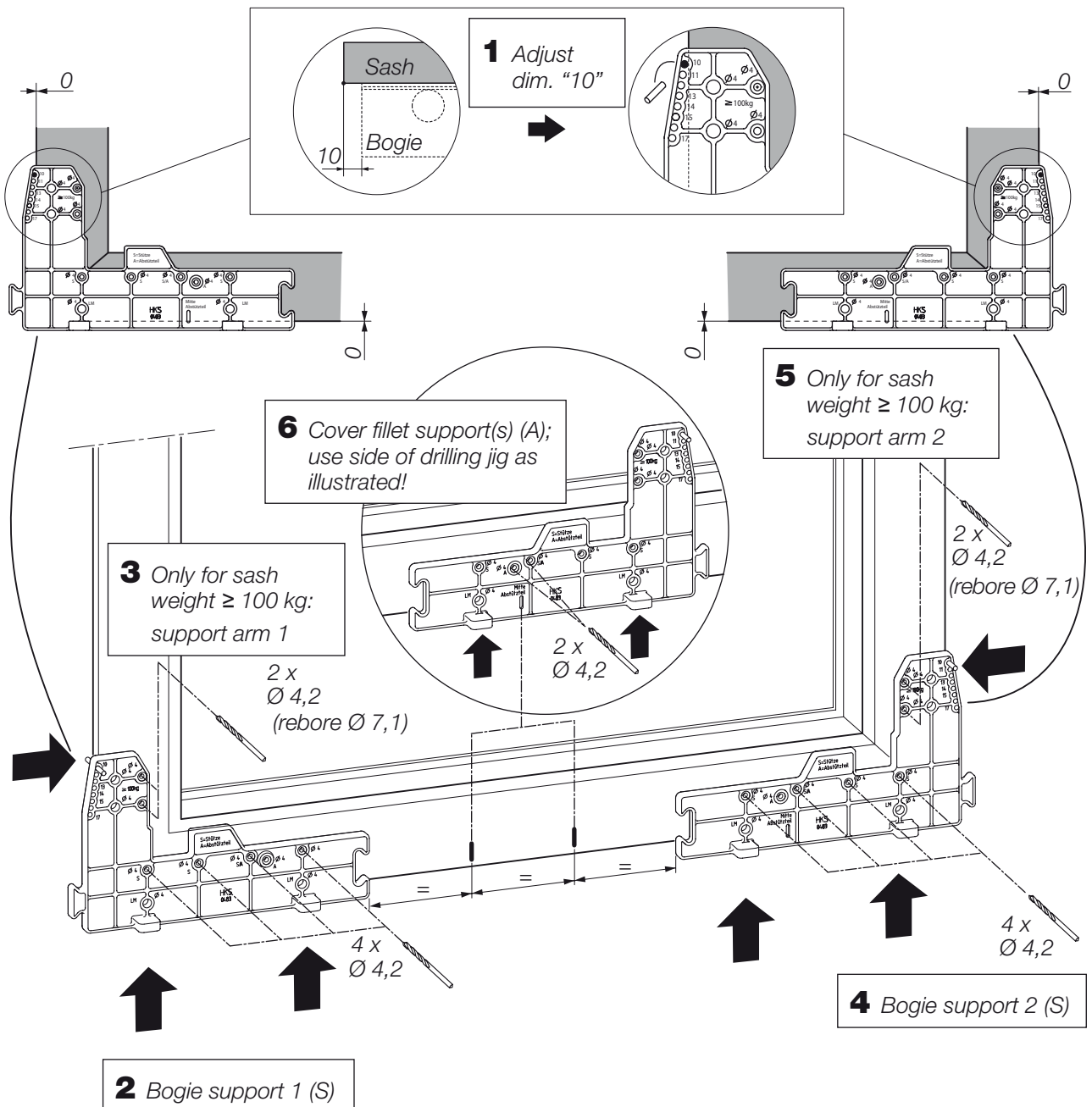
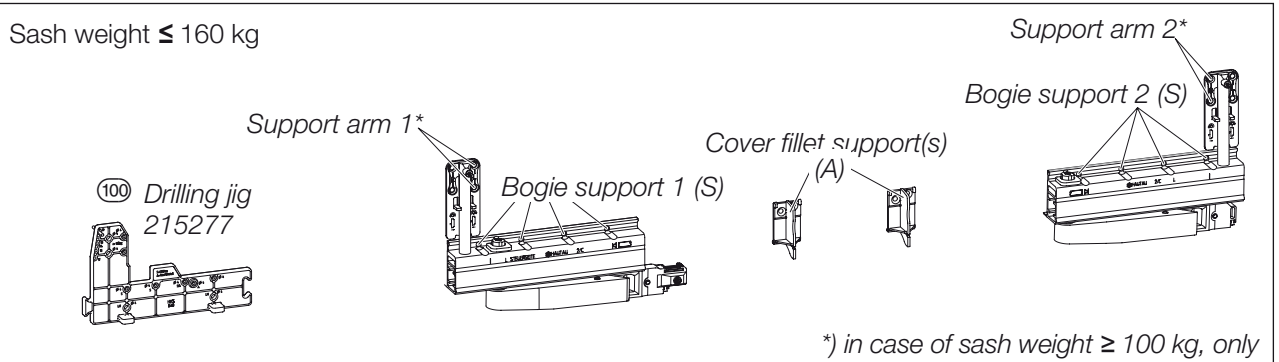

# TWIN bogies, cover fillet supports, support arms



## Mounting TWIN bogies, cover fillet support and support arms for ATRIUM® Alu-HKS 200 Z

Sash weight > 160 kg

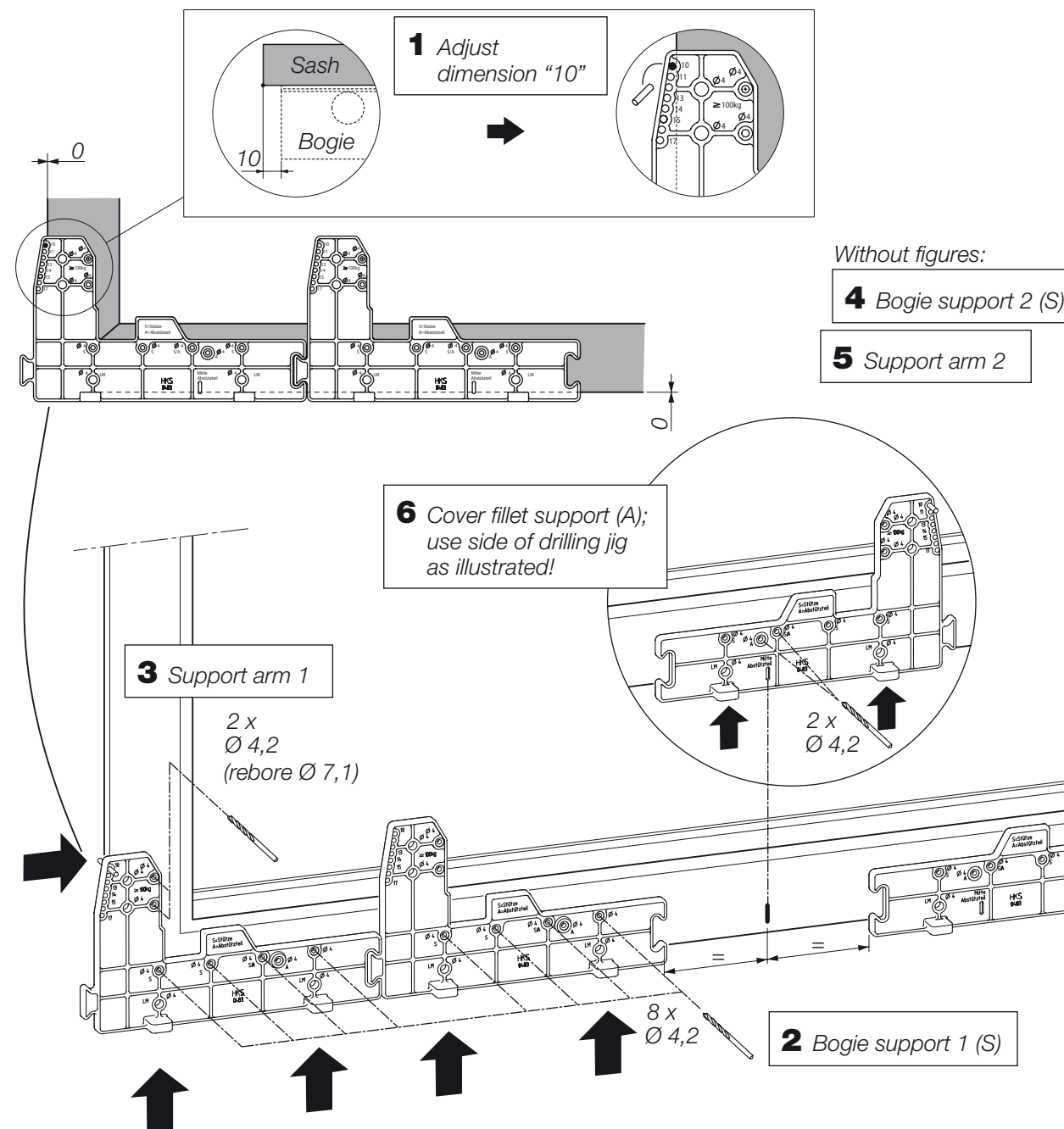
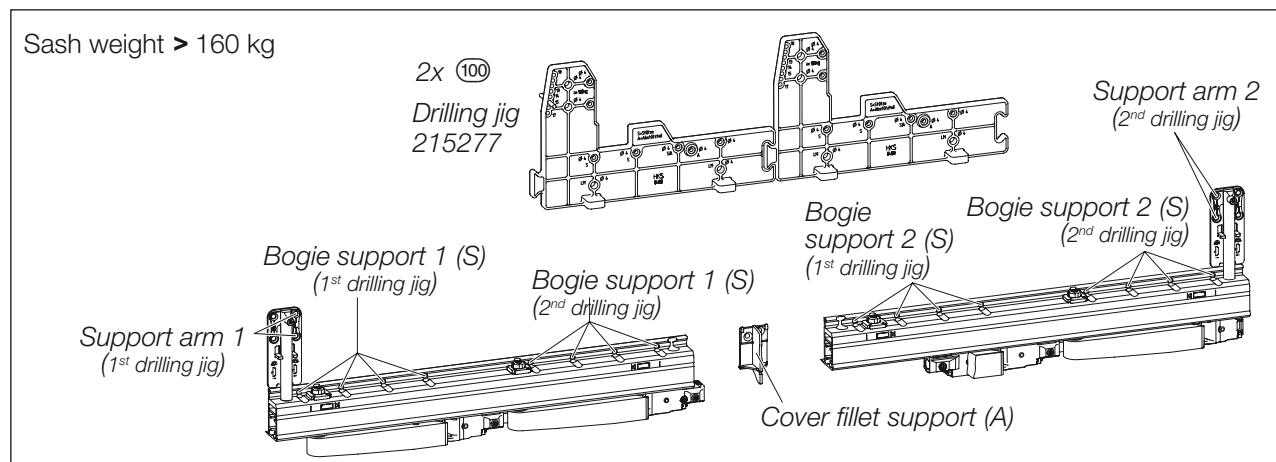

## Guide track

### Mounting guide track

for ATRIUM® Alu-HKS 160 S / 160 S oV / 200 Z

**1** Cut guide track to size

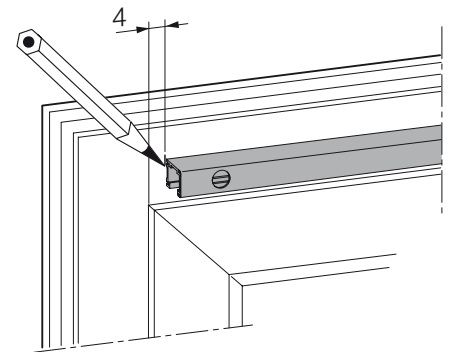
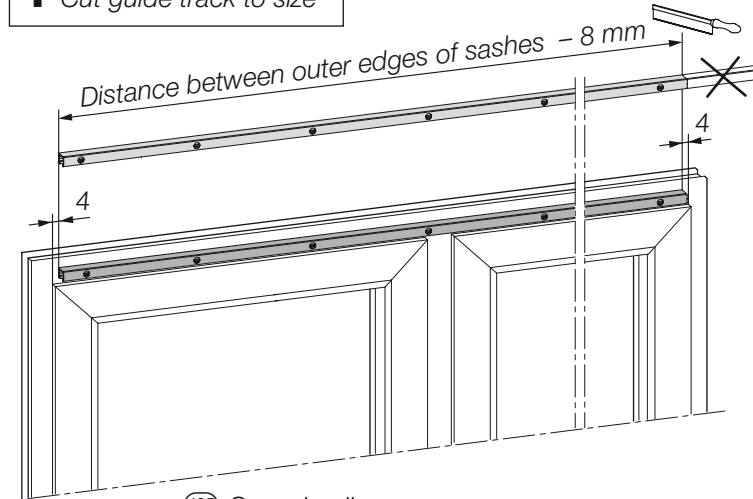

**2** Mark lateral alignment of guide track on both sides

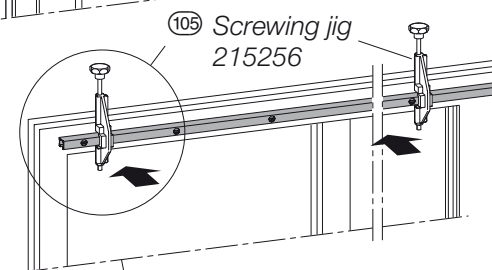

**3** Fasten screwing jigs at frame

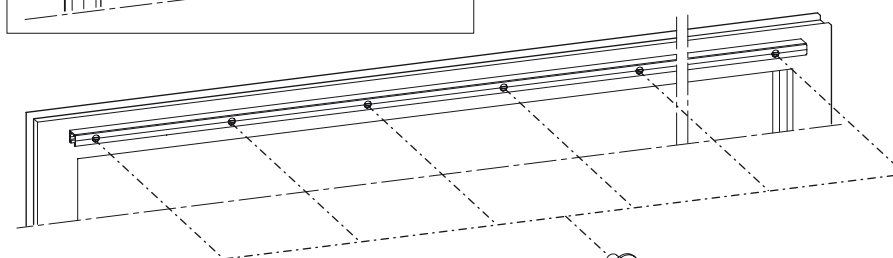
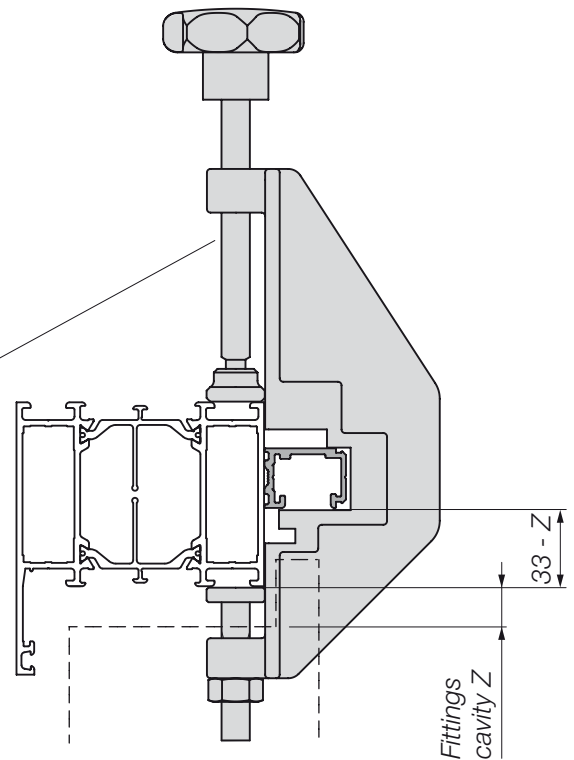
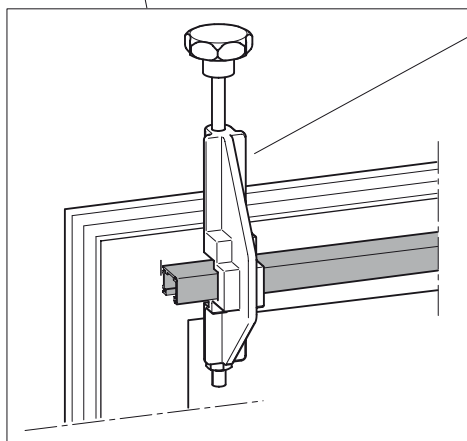

**4** Drill bore holes

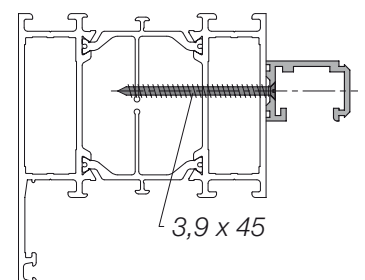
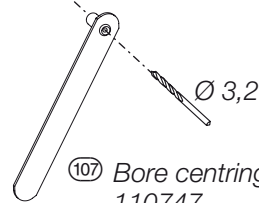

## Bottom track

### Mounting bottom track

for ATRIUM® Alu-HKS 160 S / 160 S oV / 200 Z

- 1** Cut bottom track to size at non-handle side

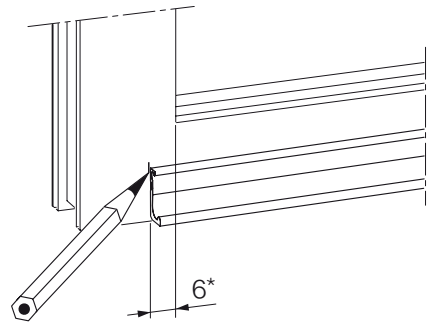
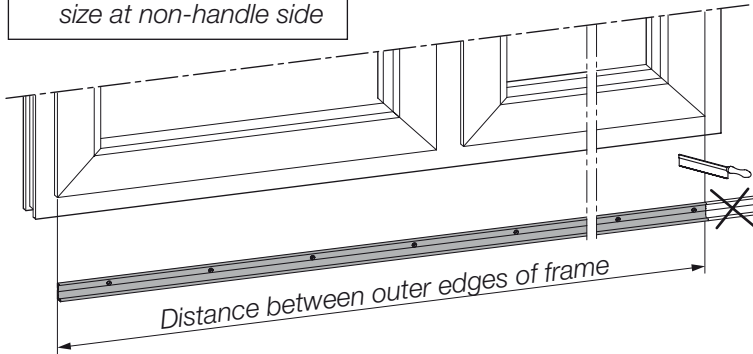

\* for 6 mm sash overrebate

- 2** Mark lateral alignment of bottom track

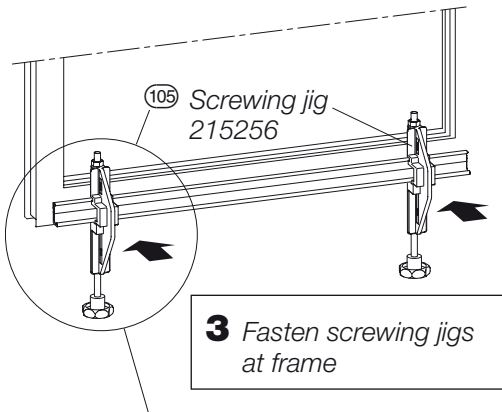

- 3** Fasten screwing jigs at frame

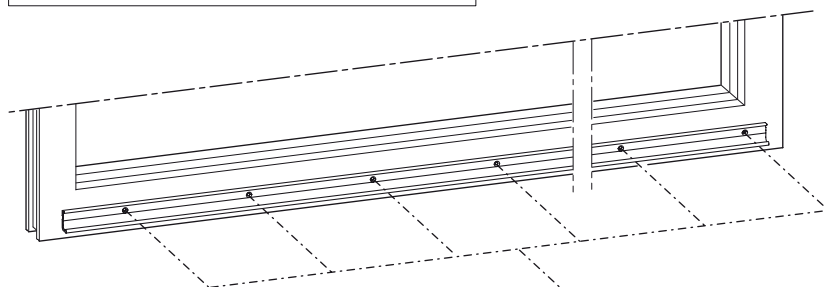
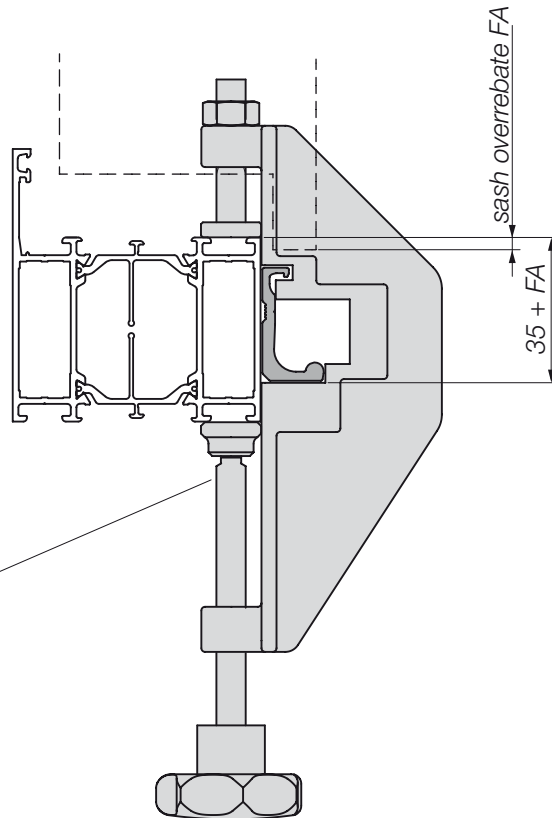
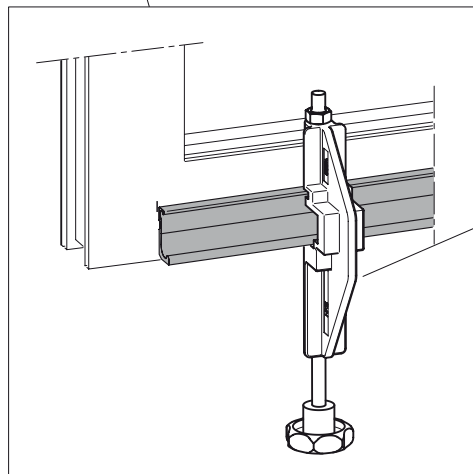

- 4** Drill bore holes

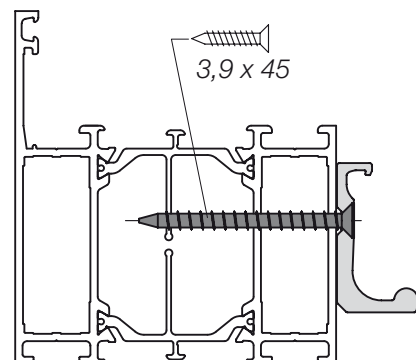
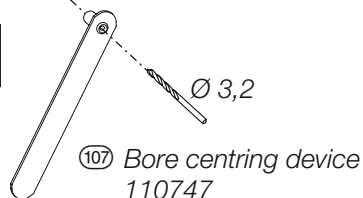



## Bogie safety device

### Deactivating bogie safety device

for ATRIUM® Alu-HKS 160 S / 160 S oV / 200 Z

During the mounting process, it may be necessary to remove the sash again. In this case, the bogie safety devices have to be moved out of the safety position in the following way:

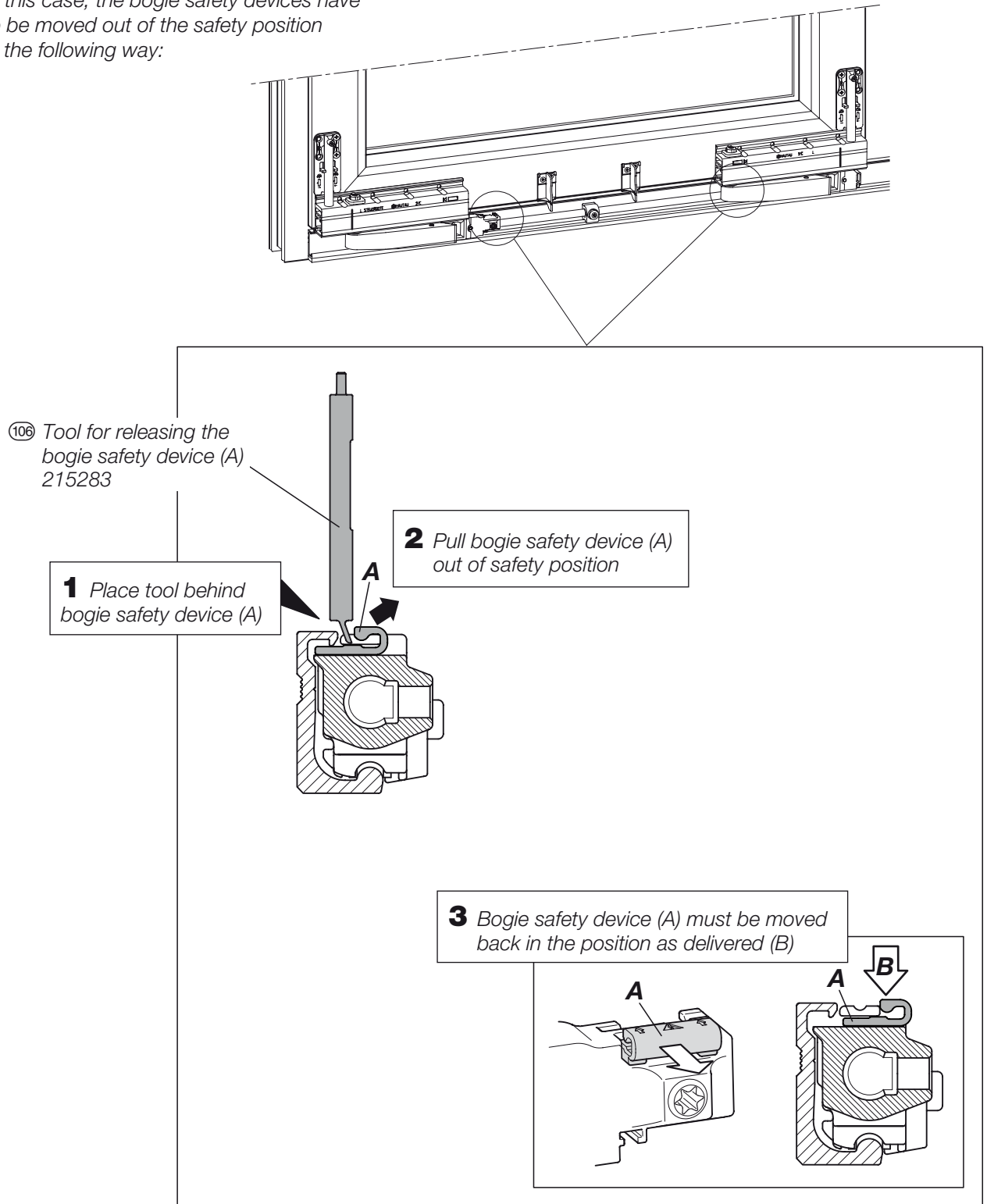

## Sliders

### Releasing sliders

for ATRIUM® Alu-HKS 200 Z



#### Warning:

If the stay cams have not engaged safely in the sliders, the sash is not secured against falling out. Severe injuries could be the consequence.

During the mounting process, it may be necessary to remove the sash again. In this case, the stay cams have to be separated from the sliders in the following way:

#### 1 Open sash

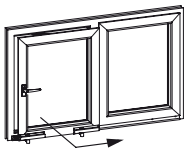

#### 2 Move bogie safety device (A) in unlocked position (B) (see also section "Bogie safety device")

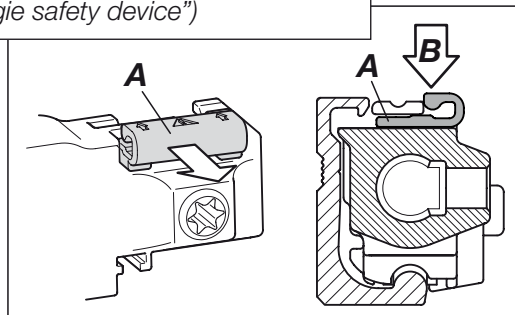

#### 3 Push tool from below into slider opening beside safety pusher until flush positioning

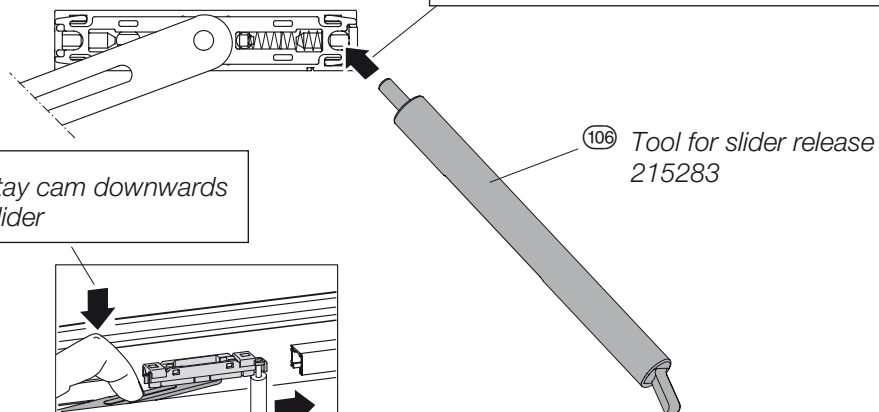

#### 5 Press stay cam downwards out of slider

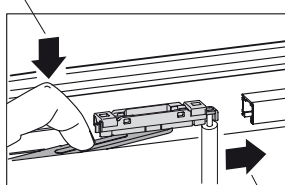

#### 4 Pull safety pusher with tool sideways out of slider

#### 6 Repeat process with second slider. Slightly tilt the released sash and lift it from bottom track (not shown).

## Guide block

### Mounting guide block

for ATRIUM® Alu-HKS 160 S / 160 S oV / 200 Z

- 1** Adjust dimension Y by means of adjustment screw

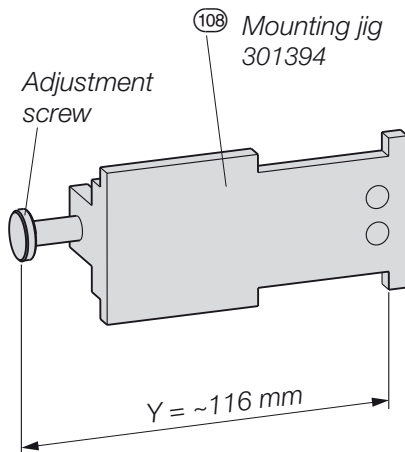

- 5** Move sash into tilt position and control fittings cavity on both sides (11,5 mm); reset guide block, if necessary

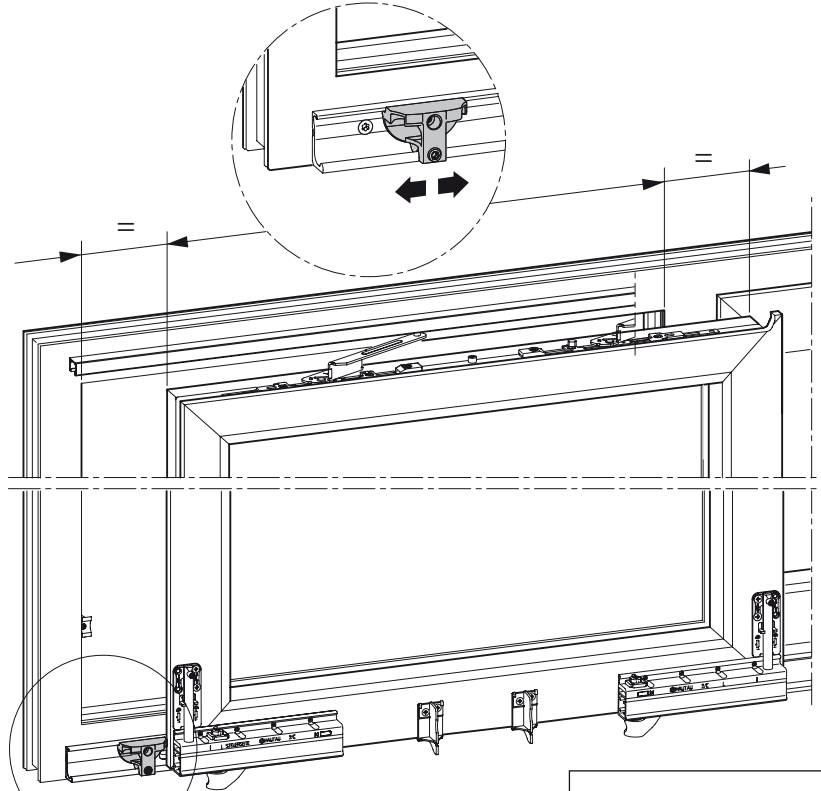

- 6** Tighten both screws at guide block:
1. 4 ... 5 Nm
  2. 2 ... 3 Nm

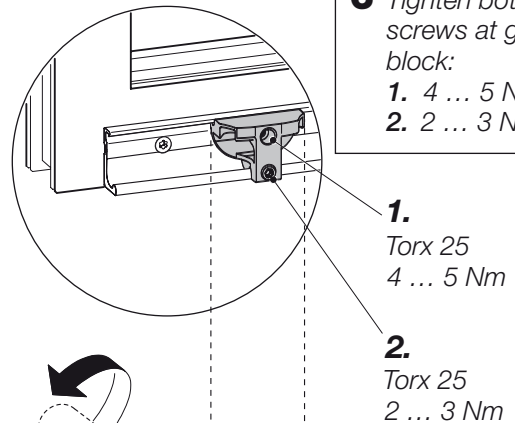

- 3** Place mounting jig as illustrated

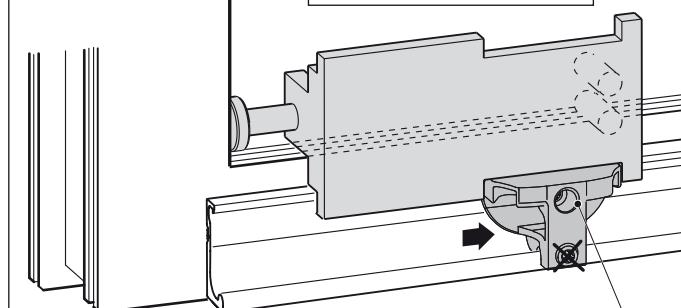

- 2** Move guide block into bottom track on handle side

- 4** Slightly fasten top screw for guide block

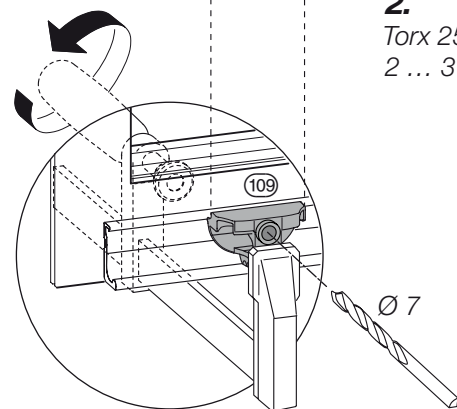

- 7 Movable guide block (optional):**  
Mark position. Replace standard guide block by jig for movable guide block (109), fix it and drill with borer Ø 7 mm

